

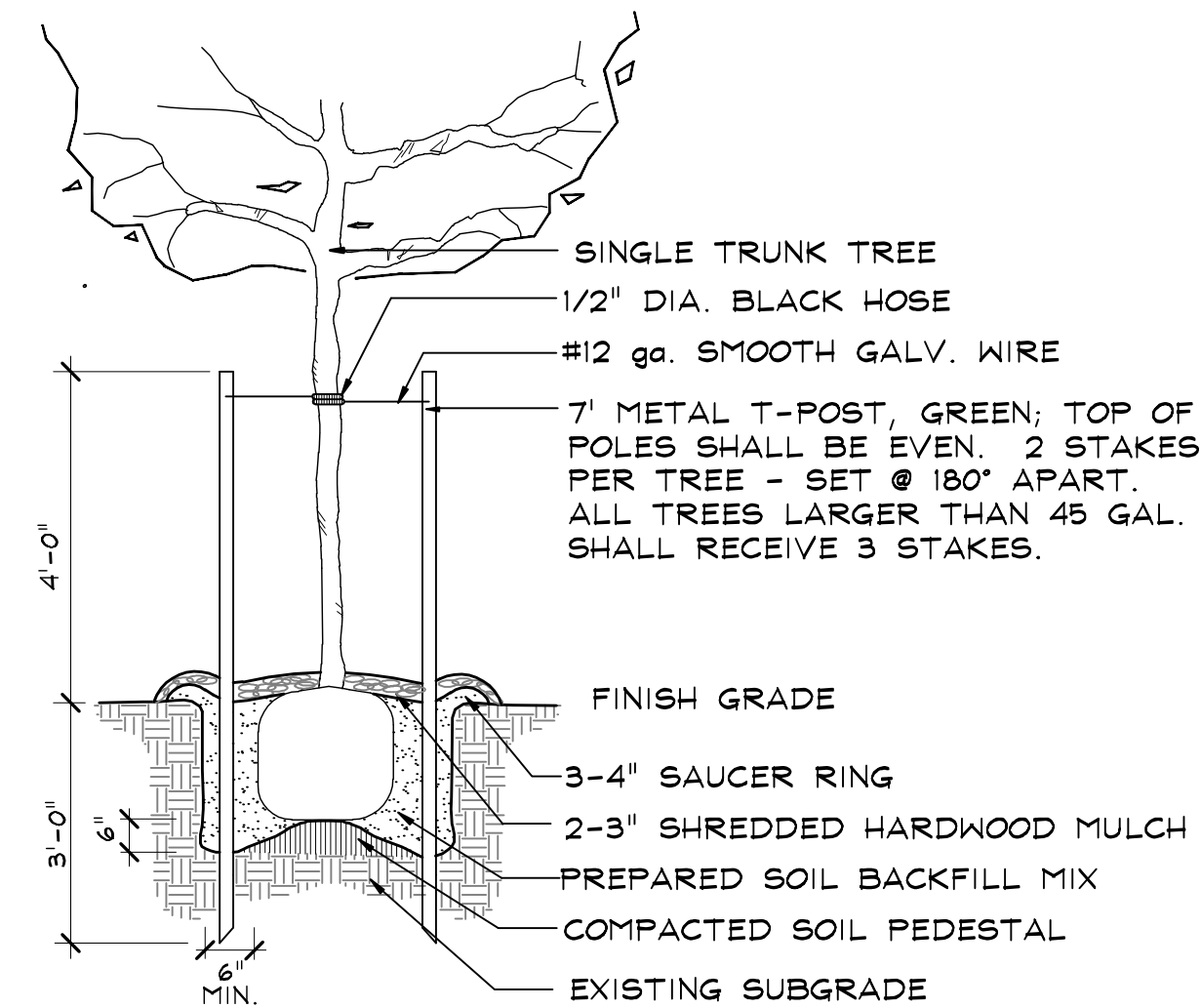

**NOTES:**

1. CONTRACTOR SHALL APPLY FOR AND PROCURE ALL REQUIRED PERMITS PRIOR TO COMMENCING WORK.
2. CONTRACTOR SHALL LOCATE ALL UNDERGROUND UTILITIES PRIOR TO COMMENCING WORK. CONTACT ALL UTILITY COMPANIES MINIMUM 48 HOURS PRIOR TO ANY WORK. CONTRACTOR SHALL BE RESPONSIBLE FOR BECOMING FAMILIAR WITH ALL UNDERGROUND UTILITIES, PIPES, STRUCTURES, ETC. CONTRACTOR SHALL TAKE SOLE RESPONSIBILITY FOR ANY COST INCURRED DUE TO DAMAGE OF THESE UTILITIES.
3. CONTRACTOR SHALL NOT WILLFULLY PROCEED WITH CONSTRUCTION AS DESIGNED WHEN IT IS OBVIOUS THAT UNKNOWN OBSTRUCTIONS AND/OR GRADE DIFFERENCES EXIST THAT MAY NOT HAVE BEEN FORESEEN IN THE DESIGN. SUCH CONDITIONS SHALL BE BROUGHT UP TO THE OWNER'S REPRESENTATIVE. THE CONTRACTOR SHALL ASSUME FULL RESPONSIBILITY FOR ANY NECESSARY CHANGES DUE TO FAILURE TO GIVE SUCH NOTIFICATION.
4. CONTRACTOR SHALL COORDINATE ALL WORK WITH OTHER SUBCONTRACTORS ON THE JOBSITE AS REQUIRED TO COMPLETE CONSTRUCTION.
5. CONTRACTOR TO PROVIDE SAMPLES OF EACH SHRUB AND GROUND COVER SPECIES OR NURSERY SOURCE FOR APPROVAL BY LANDSCAPE ARCHITECT PRIOR TO INSTALLATION. ALL PLANTS ARE TO BE SPECIMEN QUALITY, FULL POT AND HEAD, SYMMETRICAL FOLIAGE AND BRANCHING STRUCTURE. SHRUBS SHALL BE FULL TO GROUND. PLANT MATERIAL OF THE SAME SPECIES SHALL BE OBTAINED FROM THE SAME SOURCE. MATERIAL SHALL BE SHIPPED DIRECTLY FROM NURSERY AND NOT FROM CONTRACTOR'S HOLDING YARD AFTER AN EXTENDED PERIOD. LANDSCAPE ARCHITECT RESERVES THE RIGHT TO REJECT ANY AND ALL PLANT MATERIAL THAT DOES NOT MEET SATISFACTORY EXPECTATIONS OF LANDSCAPE ARCHITECT.



**C - TREE PLANTING**  
SCALE: NTS

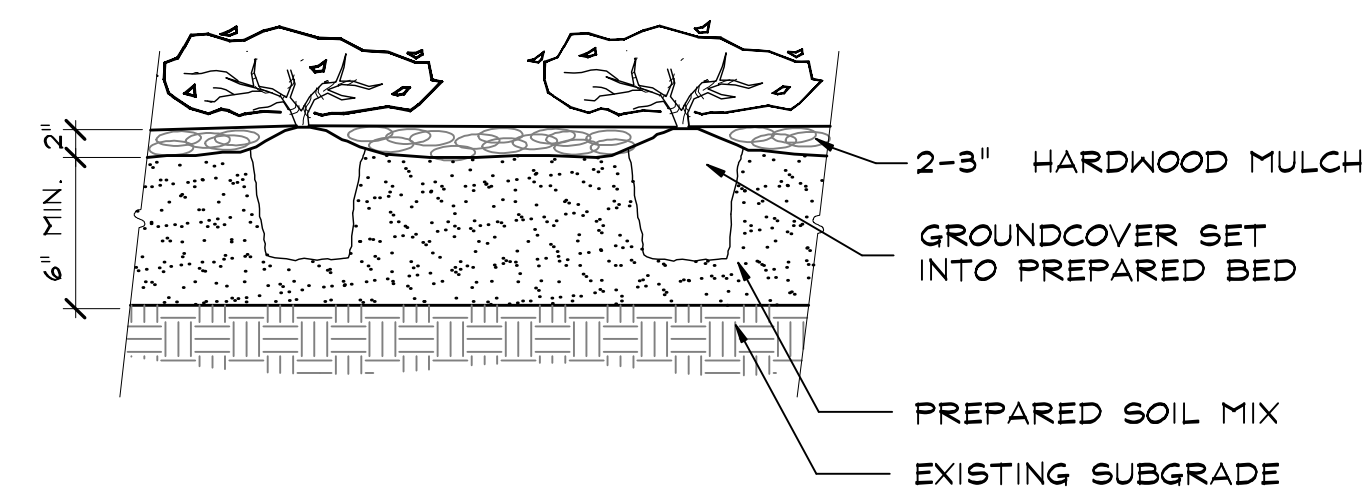

**B - GROUND COVER PLANTING**  
SCALE: NTS

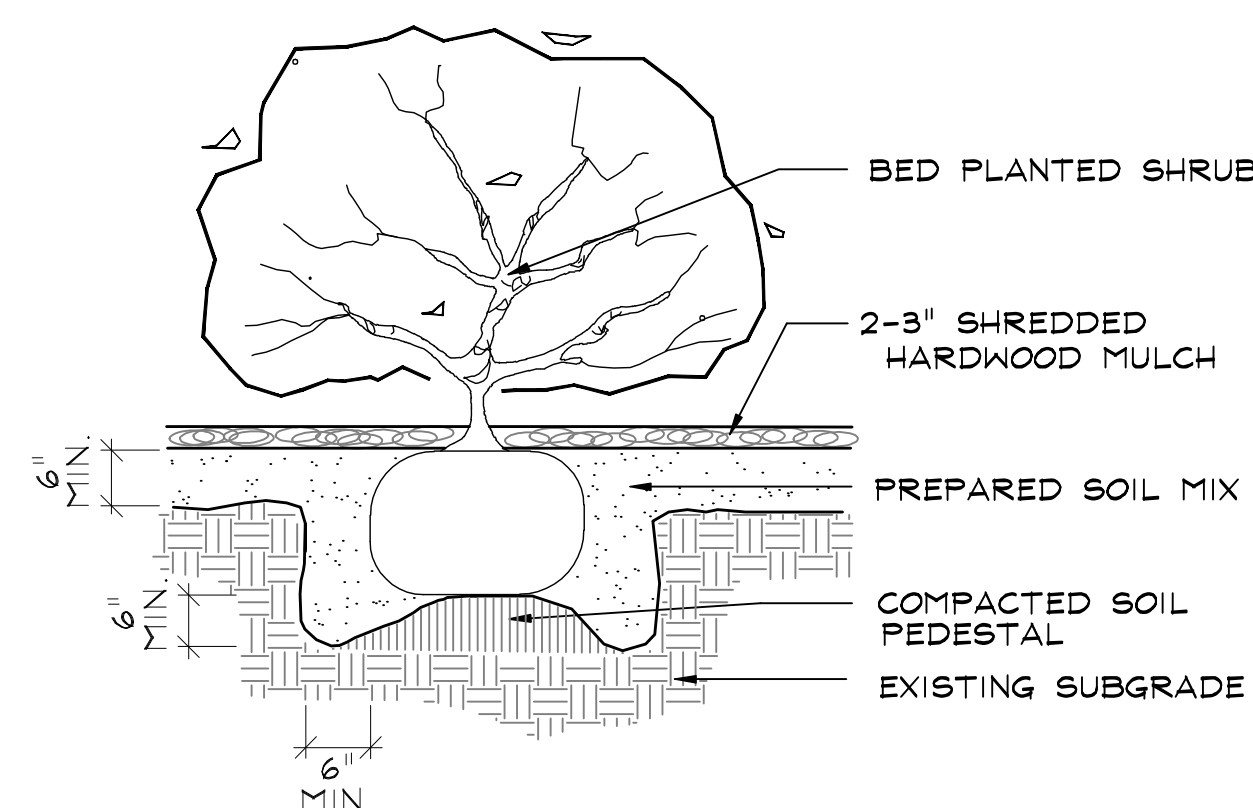

**A - SHRUB PLANTING**  
SCALE: NTS

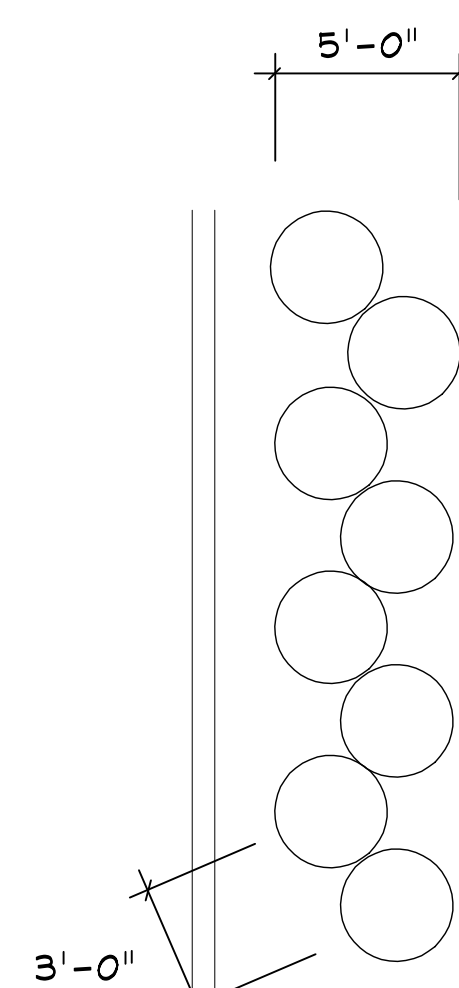

**D - SHRUB SCREENING DETAIL**  
SCALE: NTS

**PLANT LIST**

SYMBOL	QTY	COMMON NAME	SCIENTIFIC NAME	SIZE	REMARKS
(+)	28	LIVE OAK	<i>Quercus virginiana</i>	45gal	2.5" cal.; 10-12'ht; 7-8'sprd; specimen; CONTAINER GROWN
(*)	2	CRAPEMYRTLE	<i>Lagerstroemia x faurei 'Tuscarora'</i>	30gal	8-10'ht; 5-6'sprd.; Multi trunk, min. 3 canes
(⊙)	11	WAXMYRTLE	<i>Myrica cerifera</i>	10gal	48" ht.; 48" sprd. Full, rooted.
(⊙)	4	NEEDLEPOINT HOLLY	<i>Ilex cornuta 'Needle Point'</i>	7gal	36" ht.; 24" sprd. Full, rooted. PYRAMIDAL
(○)	290	WAX LIGUSTRUM	<i>Ligustrum japonicum</i>	3gal	30" ht.; 24" sprd. Full, rooted.
(⊙)	95	INDIAN HAWTHORN	<i>Raphiolepis indica 'Clara'</i>	3gal	20" ht.; 20" sprd. Full, rooted.
(○)	50	RED DRIFT ROSE	<i>Rosa 'Meigalpio'</i>	3gal	18" ht.; 18" sprd. Full, rooted.
(⊙)	44	PINK DRIFT ROSE	<i>Rosa 'Meijacos'</i>	3gal	18" ht.; 18" sprd. Full, rooted.
(⊙)	16	FOXTAIL FERN	<i>Asparagus meyeri 'Foxtail Fern'</i>	3gal	18" ht.; 18" sprd. Full, rooted.
(○)	38	KNOCKOUT ROSE DOUBLE PINK	<i>Rosa 'Pink Double Knock Out - Raatkopink'</i>	3gal	24" ht.; 24" sprd. Full, rooted.
(⊙)	48	KNOCKOUT ROSE	<i>Rosa 'Radrazz'</i>	3gal	24" ht.; 24" sprd. Full, rooted.
(○)	218	BOXWOOD	<i>Buxus sempervirens</i>	3gal	24" ht.; 12" sprd. Full, rooted.
(⊙)	12	BOUGAINVILLEA	<i>Bougainvillea glabra</i>	3gal	18" ht.; 18" sprd. Full, rooted. TRAINED TO ARBOR
(*)	76	FOXTAIL FERN	<i>Asparagus meyeri 'Foxtail Fern'</i>	1gal	12" ht.; 12" sprd. Full, rooted.
(*)	200	MONDO GRASS	<i>Ophiopogon japonicus</i>	1gal	8" ht.; 8" sprd. Full, rooted.
(*)	129	DIANELLA	<i>Dianella caerulea</i>	1gal	12" ht.; 12" sprd. Full, rooted.
(*)	110	AGAPANTHUS	<i>Agapanthus africanus 'Peter Pan'</i>	1gal	12" ht.; 12" sprd. Full, rooted.
(*)	240	SEASONAL COLOR	Seasonally Appropriate	4"pot	Full, 9" o.c.
(*)		ST AUGUSTINE	<i>Stenotaphrum secundatum</i>	sod	

**CITY OF SUGAR LAND TABULATIONS**

LAKE VIEW DRIVE = 348' /50  
 7 TREES REQUIRED  
 7 TREES PROVIDED  
 (7) LIVE OAK

PARKING CALCULATION:  
 48 PARKING SPOTS

3 TREES @ 486 SF LANDSCAPE AREA  
 (4) LIVE OAKS PROVIDED  
 902 SF LANDSCAPE AREA PROVIDED

Job No.: 106-01-08

Scale:

Date: April 18, 2013

Revised: